

Custom Made By



3900 Cornhusker Highway Lincoln, NE 68504
 (402) 467-4559 1-800-567-4559 Fax(402) 467-4907

DAKOTAFEST

AUGUST 18, 19, & 20 2009

2009 TENT ORDER FORM

Company Name _____

Billing Contact _____

Mailing Address _____

City _____ State _____ Zip _____

Phone _____ Fax _____ Email _____

On Site Contact _____ Phone _____

We mail plot maps for tent location, if you would like your plot map mailed to a different address enter it below.

Size Tent _____ Color Preference _____

Premium _____, Quality _____, Frame _____, Unique _____, LT&A SUPER TENT _____

Lot Number _____ Lot Size _____

Special Needs _____

Current tax rate is 4%.

Tent Price _____ Extra Charge _____ Tax _____ Total _____

The Lessee is responsible for all contents of the tent. The Lessee is responsible for all damage to the tent, which is not weather related. The Lessor's insurance covers weather related damage to the tent itself when set by the Lessor. Fuel surcharge may apply.

SIGNED BY _____

** TERMS: A \$50.00 nonrefundable deposit is due with reservation.

Balance is due on or before July 24th.

All tents need to be emptied immediately following close of show

REMEMBER US FOR ALL YOUR COMMERCIAL TENT NEEDS

To see photos of our tents visit our web site at: www.lincolntent.com

Custom Made By



LINCOLN TENT Inc.

3900 Cornhusker Highway Lincoln, NE 68504
(402) 467-4559 1-800-567-4559 Fax(402) 467-4907

DAKOTAFEST

AUGUST 18, 19, & 20 2009

2009 TENT RENTAL SIZES & PRICES - PAGE 1

FRAME TENTS

Prices below pertain to all orders confirmed on available tents prior to July. 10th. **Be sure to order early. Balance is due July 24th.** All prices are plus tax, South Dakota's current tax rate is 4%.

FRAME TENTS - No center poles

Bright colored vinyl tops with matching sidewalls.

10 X 10 7FT WALLS	\$224.00
10 X 20 7FT WALLS	\$325.00
20 X 20 7FT WALLS	\$410.00

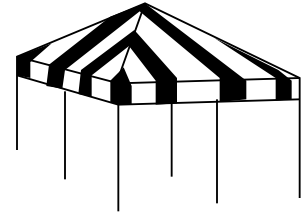

Gable Roof

Walkway Canopies

No center poles - White Tops with **No Walls**

10 X 30 7FT WALLS	\$475.00
10 X 40 7FT WALLS	\$632.00
10 X 50 7FT WALLS	\$791.00
10 X 60 7FT WALLS	\$949.00

Longer Sizes Available

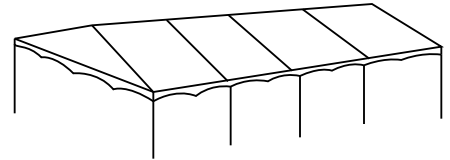

UNIQUE FRAME TENTS

A Clear-span Structure with no center poles or guy ropes. This allows you to make maximum use of your lot. The walls zip close from leg to leg to enclose your tent for added convenience and security.

10 X 20 with 7'6" Walls	\$ 422.00
10 X 30 with 7'6" Walls	\$ 475.00
10 X 40 with 7'6" Walls	\$ 632.00
10 X 50 with 7'6" Walls	\$ 791.00
20 X 20 with 7'6" Walls	\$ 510.00
20 X 30 with 7'6" Walls	\$ 673.00
20 X 40 with 7'6" Walls	\$ 898.00
20 X 50 with 7'6" Walls	\$1122.00
20 X 60 with 7'6" Walls	\$1347.00
20 X 70 with 7'6" Walls	\$1571.00
30 X 30 with 7'6" Walls	\$1010.00
30 X 45 with 7'6" Walls	\$1515.00
30 X 60 with 7'6" Walls	\$2020.00

Longer sizes available

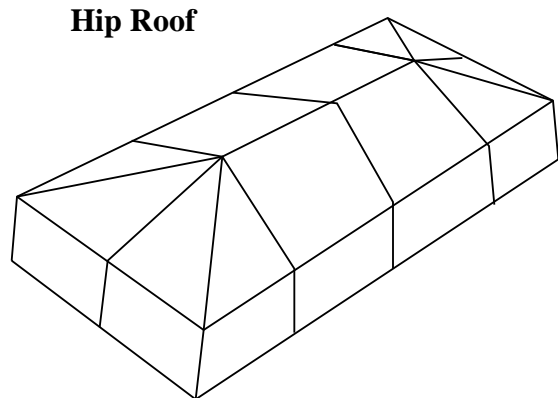

Hip Roof

9'6" Legs Available

To see photos of our tents visit our website at: www.lincolntent.com

Custom Made By



3900 Cornhusker Highway Lincoln, NE 68504
 (402) 467-4559 1-800-567-4559 Fax(402) 467-4907

DAKOTAFEST

AUGUST 18, 19, & 20 2009

2009 TENT RENTAL SIZES & PRICES - PAGE 2

The prices below pertain to all orders confirmed on available tents prior to July. 10th. Balance is due July 24th. Order early for best selection. All prices are plus tax, South Dakota's current tax rate is 4%.

PREMIUM FESTIVAL TENTS

These are bright colored vinyl tent tops with matching sidewalls. Standard colors are Red & White, Blue & White, Green & White, and Yellow & White. These are the nicest festival tents available. Their bright colors, of your choice, will help make your display stand out. These tents will have center poles and guy ropes. They will require an additional 5 feet on all sides for staking.

12 X 12 - 7FT Walls	\$214.00	60 X 60 - 8FT Walls	\$2028.00
15 X 15 - 7FT Walls	\$277.00	60 X 90 - 8FT Walls	\$2795.00
20 X 20 - 7FT Walls	\$375.00	60 X 120 - 8FT Walls	\$3438.00
20 X 30 - 7FT Walls	\$457.00	60 X 150 - 8FT Walls	\$4108.00
20 X 40 - 8FT Walls	\$553.00	60 X 180 - 8FT Walls	\$4777.00
30 X 30 - 8FT Walls	\$624.00	60 X 210 - 8FT Walls	\$5447.00
30 X 50 - 8FT Walls	\$902.00	86 X 86 - 10FT Walls	...	\$4939.00
30 X 70 - 8FT Walls	\$1167.00	86 X 115 - 10FT Walls	...	\$6490.00
30 X 90 - 8FT Walls	\$1416.00	86 X 140 - 10FT Walls	...	\$7055.00
40 X 40 - 8FT Walls	\$943.00	86 X 165 - 10FT Walls	...	\$8232.00
40 X 60 - 8FT Walls	\$1279.00	86 X 190 - 10FT Walls	...	\$9480.00
40 X 80 - 8FT Walls	\$1604.00	120 X 120 - 10FT Walls	..	\$9445.00
All sizes are approximate.			120 X 150 - 10FT Walls	.	\$11814.00
			Other sizes may be available.		

To see photos of our tents visit our website at: www.lincolntent.com

TENT SUPPLIER FOR		
WORLD PORK EXPO June 3 - 5, 2009 Des Moines, IA
FARMFEST Aug 4 - 6, 2009 Redwood Co., MN
DAKOTAFEST Aug 18 - 20, 2009 Mitchell, SD
NEBRASKA STATE FAIR Aug 28 - Sept 7, 2009 Lincoln, NE
FARM PROGRESS Sept 1 - 3, 2009 Decatur, IL
SOUTH DAKOTA STATE FAIR Sept 3 - Sept 7, 2009 Huron, SD
HUSKER HARVEST DAYS Sept 15 - 17, 2009 Grand Island, NE
OHIO FARM SHOWS Sept 22 - 24, 2009 London, OH
ICUEE Oct 6 - 8, 2009 Louisville, KY

Custom Made By



DAKOTAFEST

AUGUST 18, 19, & 20 2009

2009 TENT RENTAL SIZES & PRICES - PAGE 3

The prices below pertain to all orders confirmed on available tents prior to July. 10th.
Order early for best selection of sizes. Tops are all white. Balance is due July 24th.

LT&A SUPER TENT®

A Clear-Span Structure with no center poles or guy ropes. An ideal exhibit tent, since you do not have to work around interior poles. The LT&A SUPER TENT® also allows you to make maximum use of your lot, since it doesn't require additional area for staking. All prices are plus tax, South Dakota's current tax rate is 4%.

30 X 30 ST 8FT Walls	\$1102.00
30 X 45 ST 8FT Walls	\$1653.00
30 X 60 ST 8FT Walls	\$2203.00
40 X 30 ST 8FT Walls	\$1469.00
40 X 45 ST 8FT Walls	\$2203.00
40 X 60 ST 8FT Walls	\$2571.00
40 X 75 ST 8FT Walls	\$3213.00
50 X 30 ST 8FT Walls	\$1836.00
50 X 45 ST 8FT Walls	\$2754.00
50 X 60 ST 8FT Walls	\$2907.00
50 X 75 ST 8FT Walls	\$3633.00
60 X 30 ST 8FT Walls	\$2203.00
60 X 45 ST 8FT Walls	\$2856.00
60 X 60 ST 8FT Walls	\$3489.00
60 X 75 ST 8FT Walls	\$4361.00
60 X 90 ST 8FT Walls	\$5233.00
60 X 105 ST 8FT Walls	...	\$6105.00
80 X 90 SUPER TENT 10FT Walls	\$7711.00
80 X 105 SUPER TENT 10FT Walls	\$8997.00
80 X 120 SUPER TENT 10FT Walls	\$10282.00

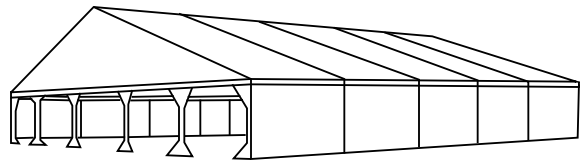

LONGER SIZES AVAILABLE IN ALL WIDTHS

CONTACT US FOR QUOTES ON SPECIAL NEEDS SUCH AS:

**FANS
STAGING**

**SPECIALTY BANNERS
CUSTOM LOGOS ON TENTS**

**SCREEN WALLS
FLAG POLES**

LEVEL ANY AREA WITH FLOORING & CARPET

To see photos of our tents visit our web site at: www.lincolntent.com

Custom Made By



3900 Cornhusker Highway Lincoln, NE 68504
 (402) 467-4559 1-800-567-4559 Fax(402) 467-4907

DAKOTAFEST

AUGUST 18, 19, & 20 2009

2009 TENT RENTAL SIZES & PRICES - PAGE 4

The prices below pertain to all orders confirmed on available tents prior to July. 10th.
 Order early for best selection of sizes. All prices are plus tax, South Dakota's current tax rate is 4%.
 These tents will have center poles and guy ropes. They will require an additional 5 feet on all sides for staking.
 Balance is due on or before July 24th.

All tents must be emptied immediately following close of show.

QUALITY FESTIVAL TENTS

All tents are complete with walls and come in a large variety of colors

12 X 12 - 7FT Walls \$199.00	40 X 40 - 8FT Walls \$744.00
15 X 15 - 7FT Walls \$247.00	40 X 60 - 8FT Walls \$938.00
20 X 20 - 7FT Walls \$327.00	40 X 80 - 8FT Walls \$1148.00
20 X 30 - 7FT Walls \$384.00	40 X 100 - 8FT Walls \$1385.00
20 X 40 - 8FT Walls \$455.00	60 X 60 - 8FT Walls \$1677.00
30 X 30 - 8FT Walls \$527.00	60 X 90 - 8FT Walls \$2091.00
30 X 50 - 8FT Walls \$735.00	60 X 120 - 8FT Walls \$2506.00
30 X 70 - 8FT Walls \$930.00	60 X 150 - 8FT Walls \$2921.00
30 X 90 - 8FT Walls \$1130.00	60 X 180 - 8FT Walls \$3335.00
All sizes are approximate.	86 X 86 - 10FT Walls ... \$3764.00
	86 X 115 - 10FT Walls ... \$4917.00
	Other sizes may be available.

To see photos of our tents visit our website at: www.lincolntent.com

TENT SUPPLIER FOR

WORLD PORK EXPO	June 3 - 5, 2009	Des Moines, IA
FARMFEST	Aug 4 - 6, 2009	Redwood Co., MN
DAKOTAFEST	Aug 18 - 20, 2009	Mitchell, SD
NEBRASKA STATE FAIR	Aug 28 - Sept 7, 2009	Lincoln, NE
FARM PROGRESS	Sept 1 - 3, 2009	Decatur, IL
SOUTH DAKOTA STATE FAIR	Sept 3 - Sept 7, 2009	Huron, SD
HUSKER HARVEST DAYS	Sept 15 - 17, 2009	Grand Island, NE
OHIO FARM SHOWS	Sept 22 - 24, 2009	London, OH
ICUEE	Oct 6 - 8, 2009	Louisville, KY

